





SW300B Turbojet Engine Specifications

Advantages:

- **Compact size and weight:2500g**
- **Twin glowplug ignition system:can startup below -30°C**
- **High compression ration 3.6:lower fuel consumption**
- **High altitude Startup:over 4500m altitude**
- **Telemetry protocol support:controlled by computer or auto-pilot**
- **Diesel/kerosene(Jet a1) or mix use, no need extra adjust parameters**
- **High flying altitude:>8000m altitude**
- **High flying speed:>300m/s**

SW300B/300Pro component list:

No.	Item	300B	Qty
1	Engine and fix ring		1
2	Engine controller (ECU)	<p>V3 ECU</p>  <p>The SWIWIN V3 ECU was designed from the ground up and is based on 32 bit microprocessor functionality and designed specifically for SWIWIN Turbines.</p> <p>The V3 ECU offers the following benefits:</p> <ul style="list-style-type: none"> ● Data Logging Auto start Automatic Restart ● Color Screen visible in direct sunlight ● Configurable thrust curve with very fast throttle response ● Telemetry function ● BUS input 	1

3	Cable set				1
4	Data terminal (GSU)				1
5	Ball valve				1
6	Fuel line				4x2.5mm 6x4mm
7	Fuel filter				4x2.5mm
8	Brushless pump				1

Install Dimension:

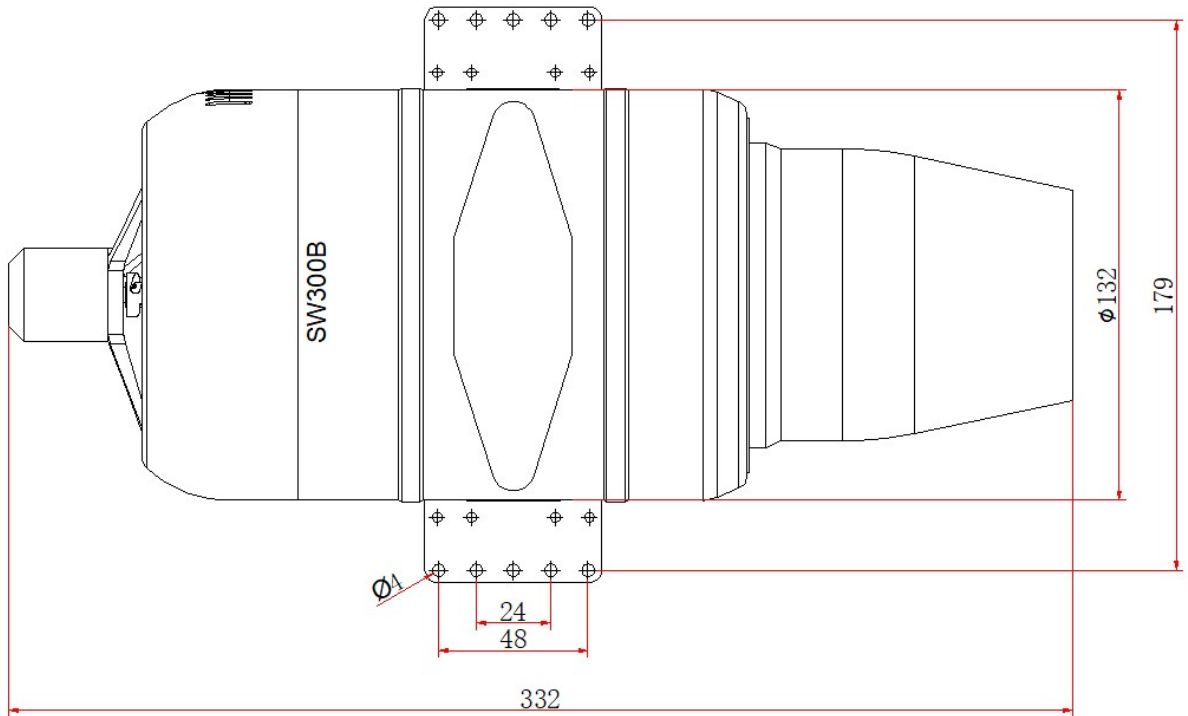

Specifications:

Model name	SW300B
Diameter	132mm
Length	332mm
Body weight	2500g
V3 ECU weight	41g
Maintenance intervals	After running 25 hours
Maximum running height	>8000m
Cruise accelerator	80%
Maximum ejection overload	10G
Maximum flight speed	>300m/s
Power battery voltage	14.8V (4S Lipo)
Startup	Full automatic fuel startup (no gas)
RPM range	33,000 - 98,000 RPM
Operation temp	-40 - 50 centigrade
Thrust	300N (centigrade 15, sea level)
Exhaust temp	centigrade 780
Max fuel consumption	820 g/m (97,000RPM)
Fuel type	Diesel or Kerosene (Jet A1)
Lubricating oil	5% Mobil jet oil

Control:

1 .Throttle signal:

The throttle adopts a pulse width (PWM) control mode. The pulse width is 1ms - 2ms, and 1ms corresponds to the minimum throttle (0%), 2ms corresponds to the maximum throttle (100%), and the pulse high level is 3.3V and 5V (3.3V And 5V electricity is available on average), and the low level of pulse is 0V.

2 .Telemetry function:

1) ECU with telemetry control / monitor function, interface UART , Serial port baud rate 9600bps - 57600bps.

2) Telemetry data includes engine rpm, throttle, pump voltage, engine temp, engine status, error message. Or add functions from communication protocol.

3) The communication protocol is open, firmware upgrade able, control / monitor program provided.

3 .Running data recorder:

1) The ECU has the data recording function, which can record engine running data 2 hours.

2) ECU recorder includes engine rpm, throttle, pump voltage, engine temp, engine status, error message. Or add functions from communication protocol.

3) Provide engine data analysis software to facilitate post flight data analysis

System connection:

SW300B:

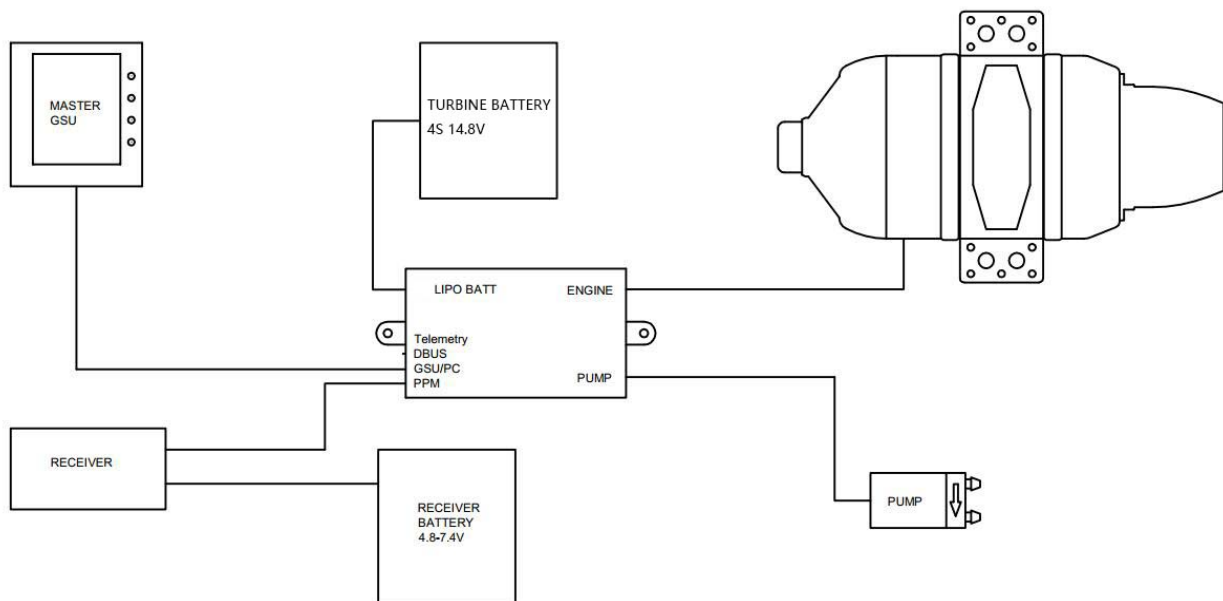

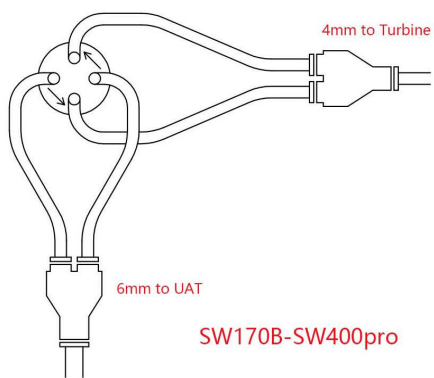
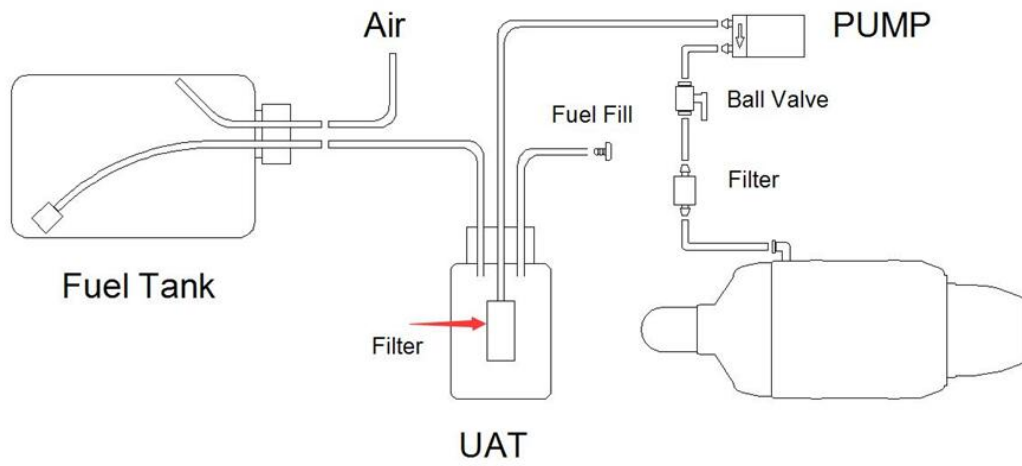

www.jetskyfly.
comjetskyfly@163.com